

 **ADOWIN[®]**

**760 SERIES
PVC PROFILE SYSTEM**

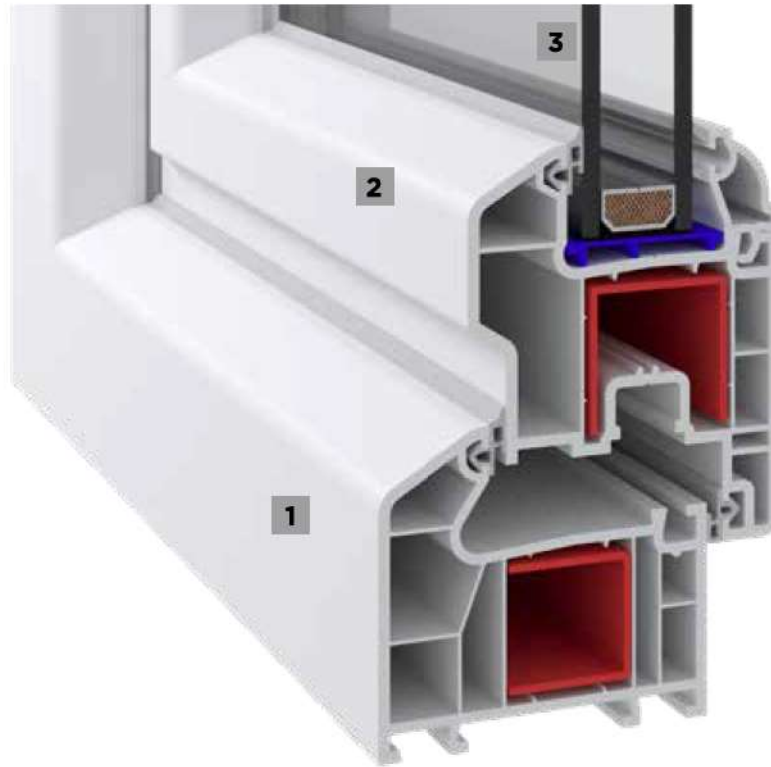

TECHNICAL

760 SERIES

Profile Width: 70 mm

Number of chambers: 5

Profile Class: B Class (TS EN 12608-1)

Seal Type: External / Internal double seal system

Seal Type and Color: TPE - Grey /Black

Glass Thickness (mm): 4, 20, 24, 30, 32 mm

The thermal insulation Uf: 1,45 W/m²K

- 1** Frame 5 chambers system.
- 2** Offset and flat sash option
- 3** Double and triple glass option.

INSTRUCTION

- The main profiles have 70 mm width.
- Because of the elastic grey and black seal which does not leave any stain on profiles will be provided maximum air, water, dust and sound isolation.
- Due to the 5 chambers profiles, it has maximum performance for thermal, sound and water isolation.
- It is a series of profiles with very special design that provides maximum wind resistance on high rise buildings.
- In addition to white profile a different laminated color range is available.
- 4-5 mm single glazing application of 4, 20, 24, 30, 32 mm glazing beads give us alternatives of using double, triple glazing and panels.

LAMINATED COLORS



760 SERIES PVC PROFILE SYSTEM

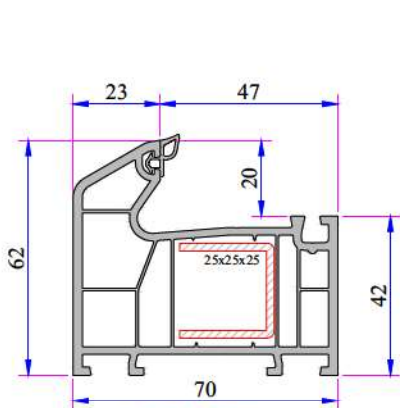

Frame Profile
P.A.706.1000.600.0.BC.03

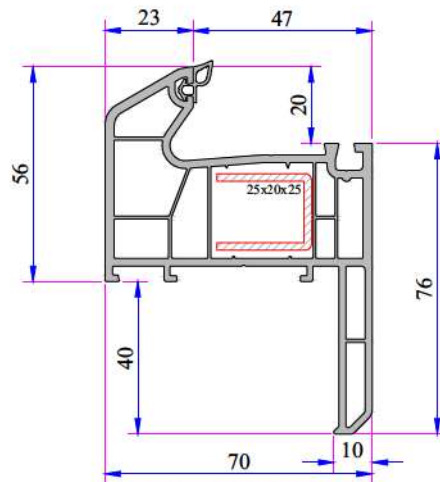

Frame Profile With Sill
P.A.706.1200.600.0.BC.03

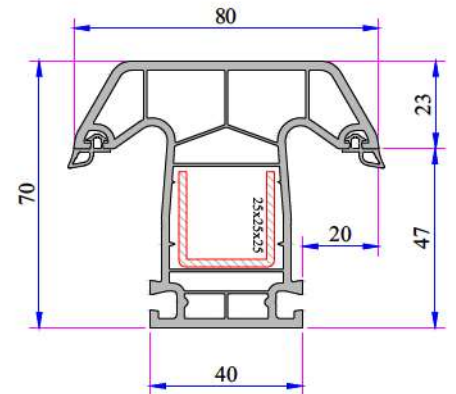

Mullion Profile
P.A.706.3000.600.0.BC.03

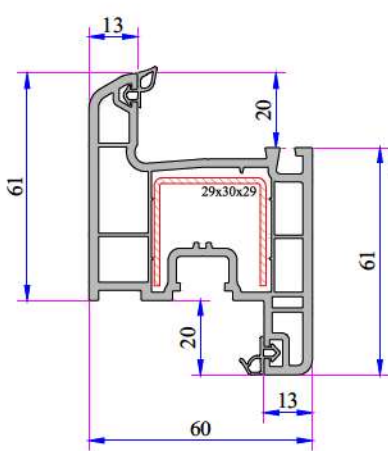

Sash Profile
P.A.632.2000.600.0.BC.03

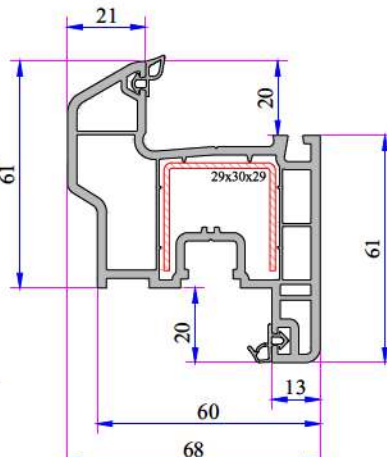

Offset Type Sash Profile
P.A.632.2200.600.0.BC.03

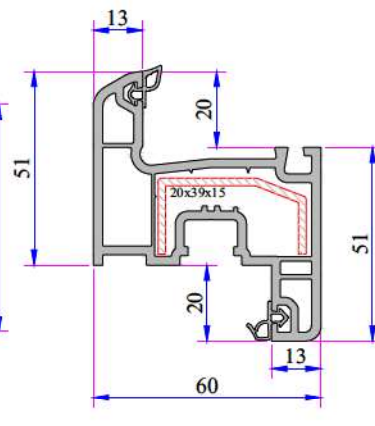

Narrow Sash Profile
P.A.900.2005.600.0.BC.03

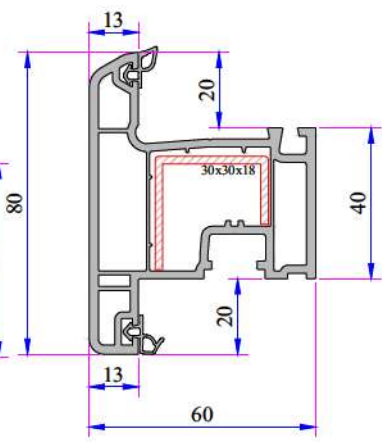

Outward Opening Sash Profile
P.A.632.2014.600.0.BC.03

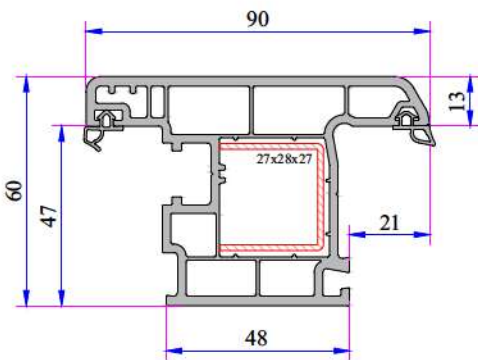

Outward Opening Sash Profile (9 Axis)
P.A.430.2001.600.0.BC.03

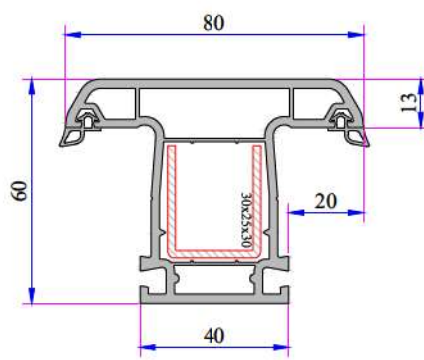

Mullion For Door Profile
P.A.632.3000.600.0.BC.03

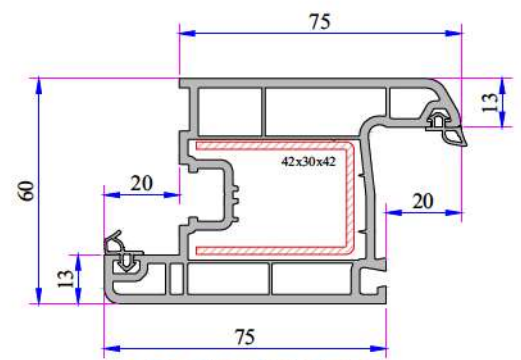

Eco Door Sash Profile
P.A.632.2107.600.0.BC.03

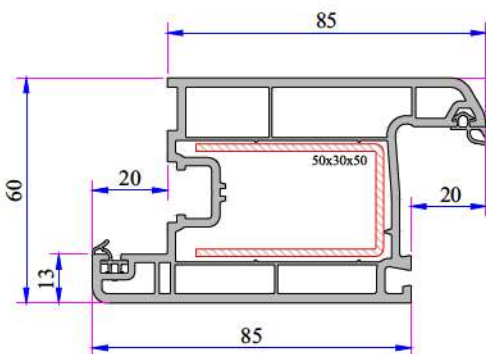

Door Sash Profile
P.A.632.2100.600.0.BC.03

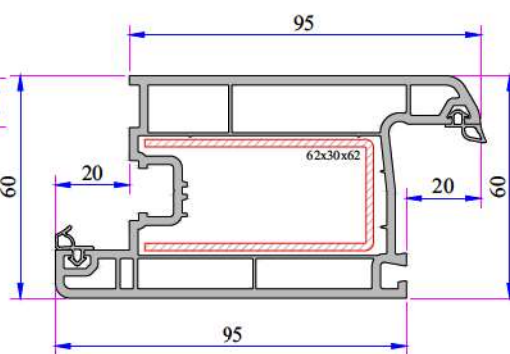

Super Door Sash Profile
P.A.632.2103.600.0.BC.03

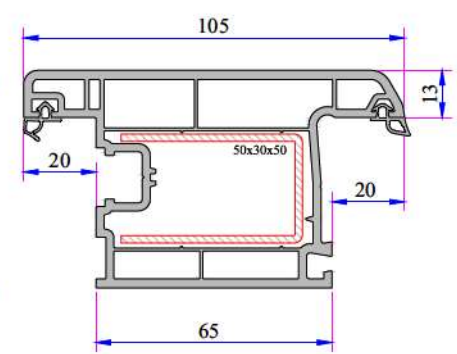

Outward Opening Door Sash Profile
P.A.632.2101.600.0.BC.03

760 SERIES PVC PROFILE SYSTEM

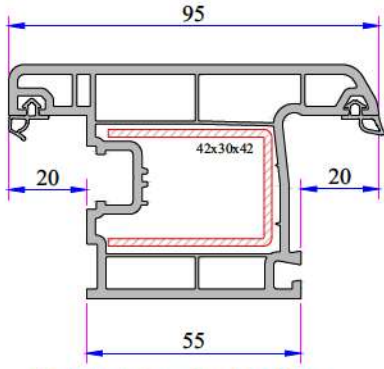

Outward Opening Eco Door Sash Profile
P.A.632.2104.600.0.BC.03

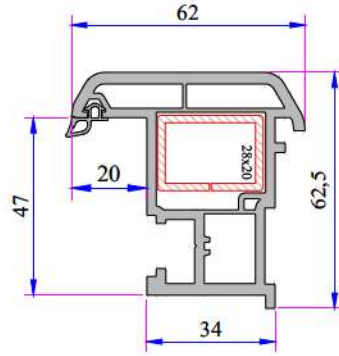

Lap Joint Profile
P.A.632.3100.600.0.BC.19

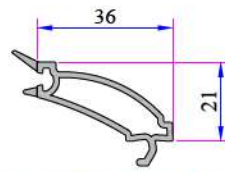

Single Glazing Bead 4-6mm
P.A.101.4002.600.0.HC

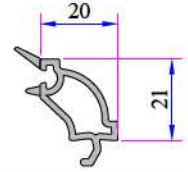

Double Glazing Bead 20mm
P.A.101.4102.600.0.HC

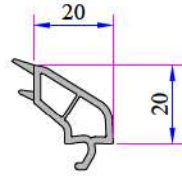

Single Glazing Bead 20mm
P.A.101.4100.600.0.HC

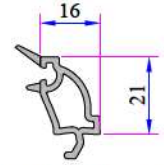

Double Glazing Bead 24mm
P.A.101.4202.600.0.HC

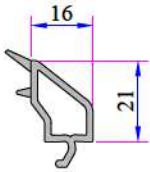

Double Glazing Bead 24mm
P.A.101.4200.600.0.HC (White)

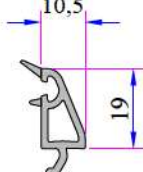

Triple Glazing Bead 30mm
P.A.332.4100.600.0.HC (White)

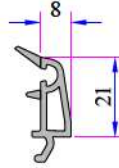

Triple Glazing Bead 32mm
P.A.101.4500.600.0.HC (White)

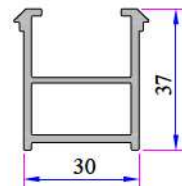

Frame Montage Profile
P.A.060.5301.600.0.00.19

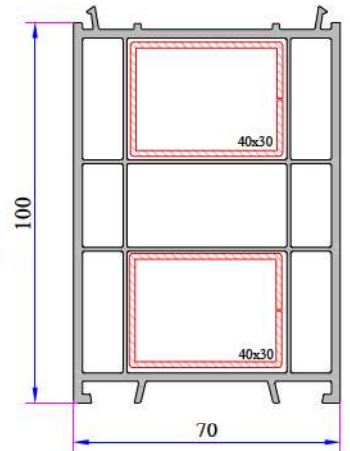

100mm Frame Lifting Profile
P.A.070.5302.600.0.00.19

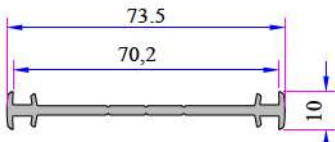

Narrow Coupling Profile
P.A.070.5001.600

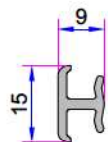

Universal Short Coupling Profile
099.5004

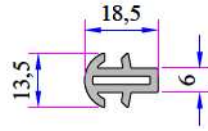

Short Coupling Profile
P.A.099.5003.600

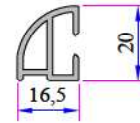

Offset Coupling Profile
P.A.900.6307.600

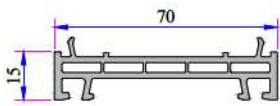

Frame Lifting Profile 15 mm
070.5304

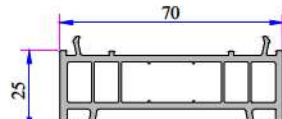

Frame Lifting Profile 25 mm
070.5306

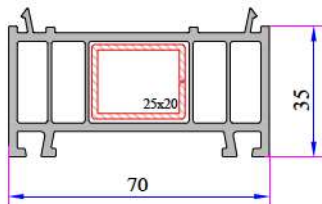

Frame Lifting Profile 35mm
P.A.070.5300.600.0.00.19

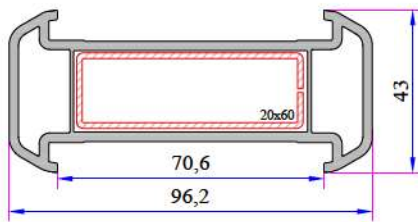

Large Coupling Profile
P.A.070.5000.600.0.00.19

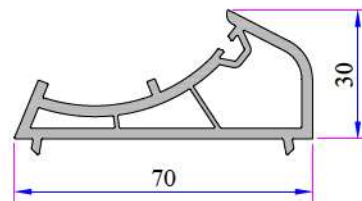

Corner Lag Profile
P.A.070.5104.600.0.00.19

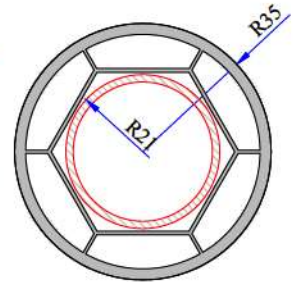

Pipe Profile
P.A.070.5106.600

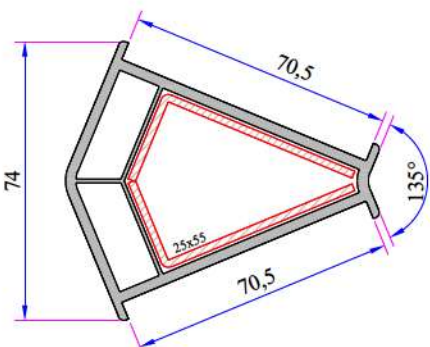

135° Corner Profile
P.A.070.5102.600.0.00.19

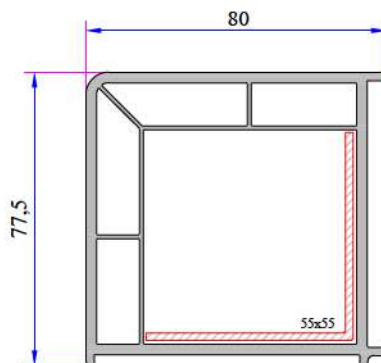

90° Corner Profile
P.A.070.5100.600.0.00.19

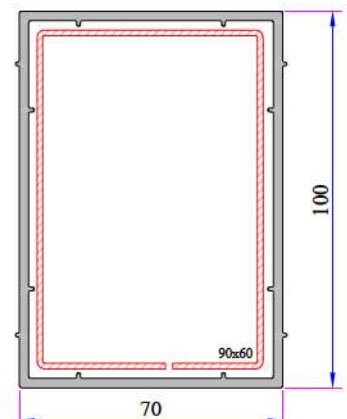

70x100mm Box Profile
P.A.070.5202.600.0.00.19

760 SERIES PVC PROFILE SYSTEM

W 760 Re-Inforcement Profiles

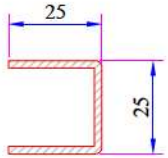

Frame - Mullion Profile Reinforcement
34022-12003

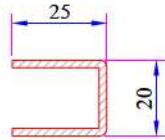

Frame with Sill Profile Reinforcement
34022-12021

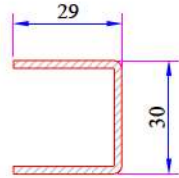

Sash - Offset Type Sash Profile Reinforcement
34022-12002

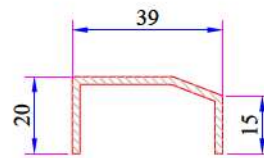

Narrow Sash Profile Reinforcement
34022-12031

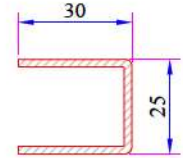

Mullion For Door Profile Reinforcement
34022-12004

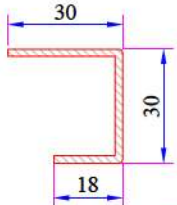

Outward Opening Sash Profile Reinforcement
34022-12022

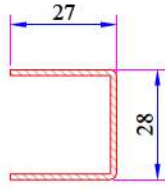

Outward Opening Sash Profile (9 Axis) Reinforcement
34022-12020

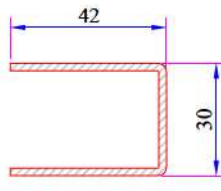

Eco Door Sash - Outward Opening Eco Door Sash Profile Reinforcement
34022-12023

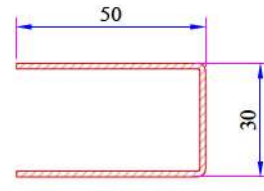

Door Sash - Outward Opening Door Sash Profile Reinforcement
34022-12013

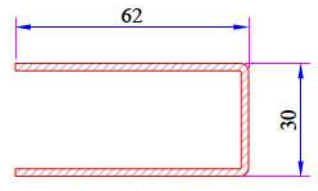

Super Door Sash Profile Reinforcement
34022-12029

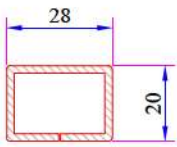

Lap Joint Profile Reinforcement
34022-12118

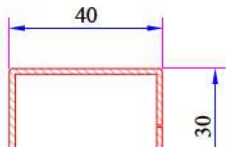

100mm Frame Lifting Profile Reinforcement
34022-12120

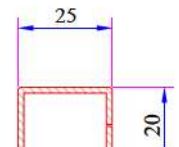

35mm Frame Lifting Profile Reinforcement
34022-12104

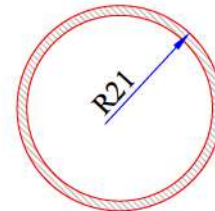

Pipe Profile Reinforcement
34022-12502

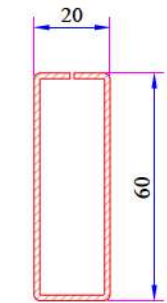

Large Coupling Profile Reinforcement
34022-12106

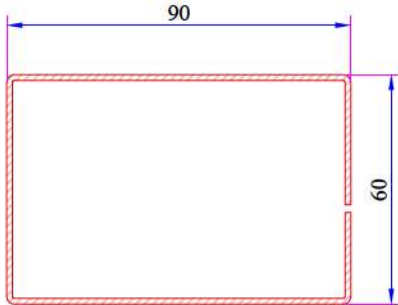

70x100 mm Box Profile Reinforcement
34022-12121

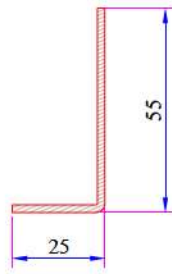

135° Corner Profile Reinforcement
34022-12303

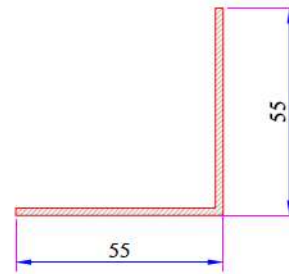

90° Corner Profile Reinforcement
34022-12305

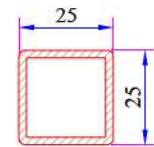

Mullion Profile Static Reinforcement
34022-12122

W 760 Installation

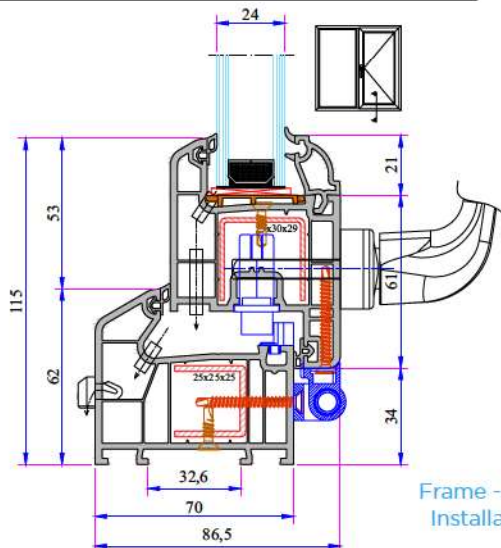

Frame - Sash Installation

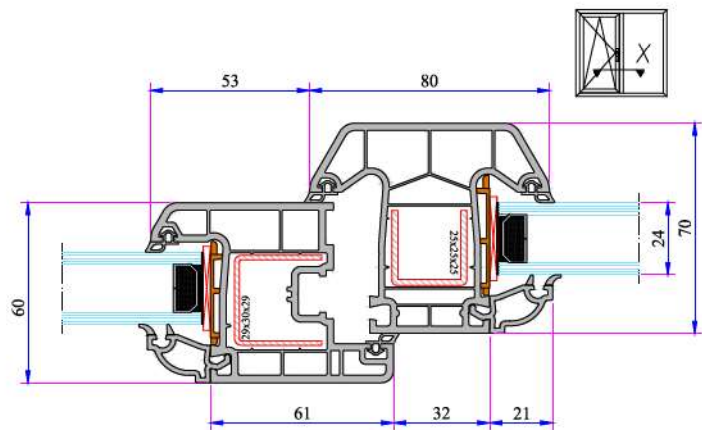

Mullion - Sash Installation

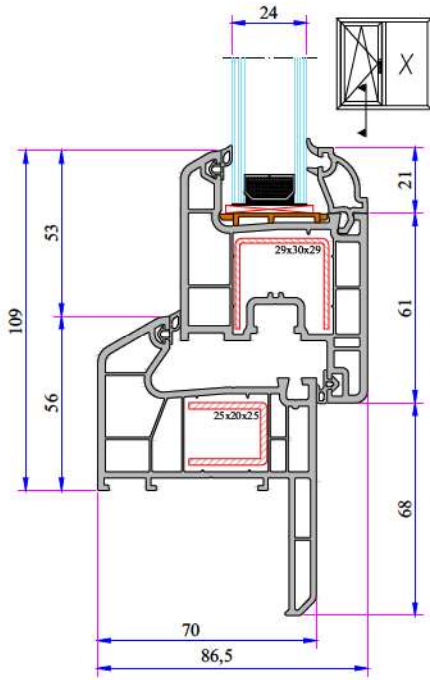

Frame with Sill - Sash Installation

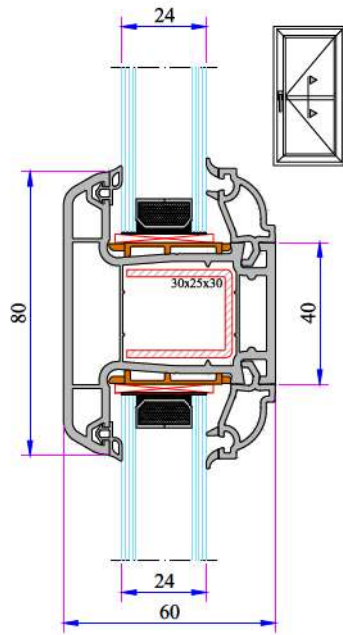

Mullion Profile Installation

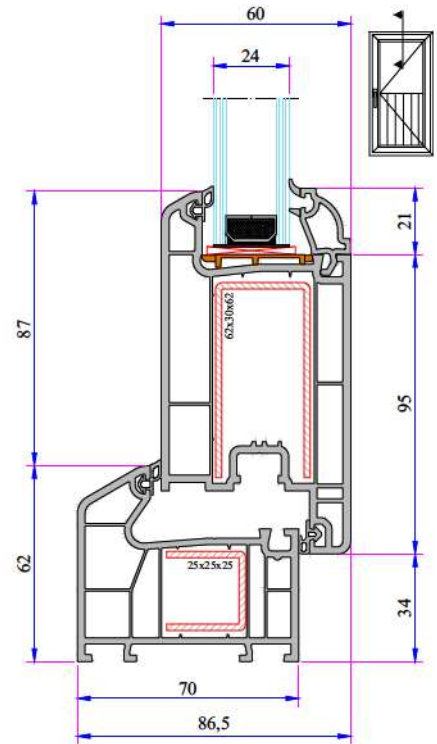

Frame - Super Door Sash Installation

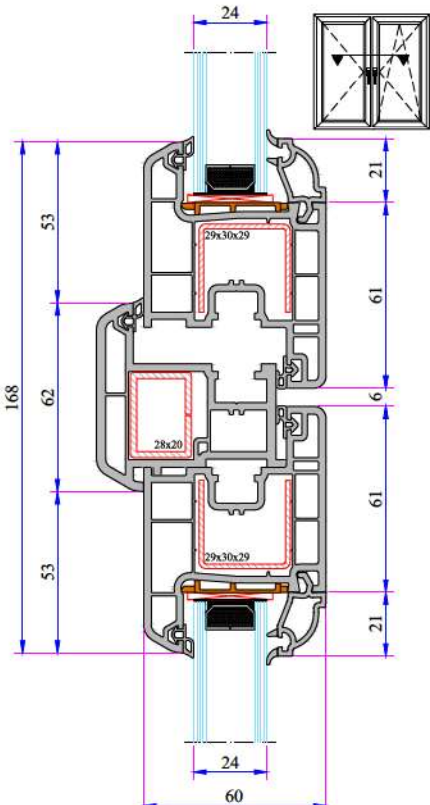

Sash - Lap Joint - Sash Installation

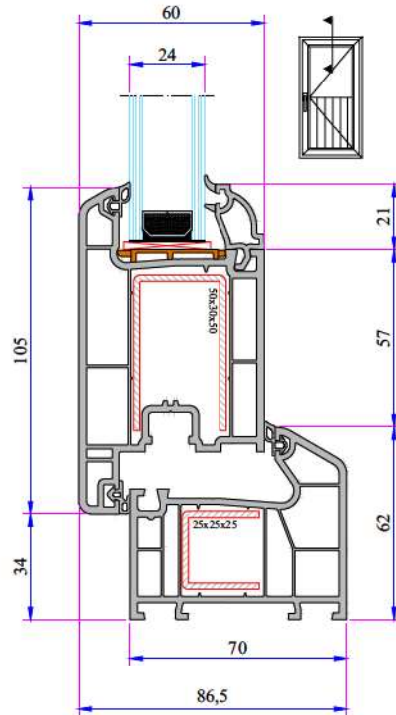

Frame - Outward Opening Door Sash Installation

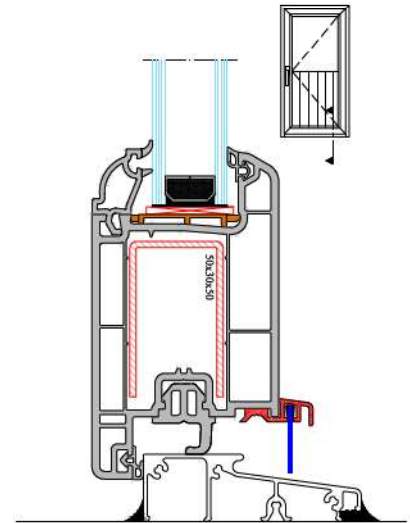

With Aluminium Threshold Frame Door Sash Installation

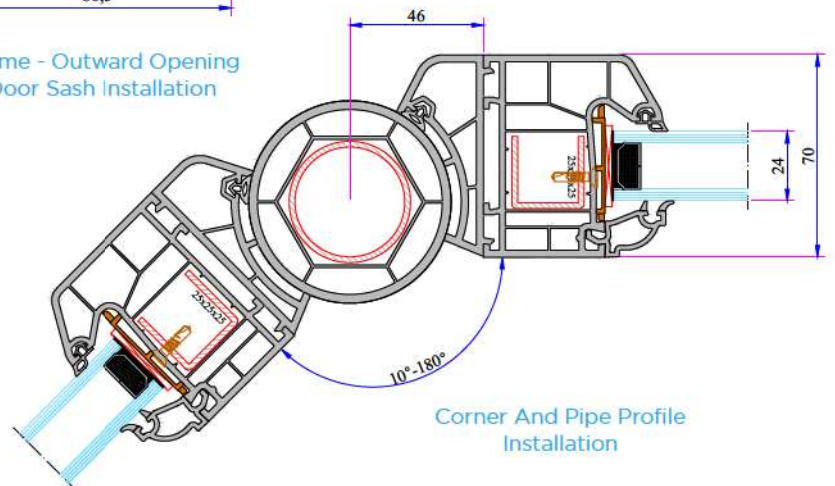

Corner And Pipe Profile Installation

760 SERIES PVC PROFILE SYSTEM

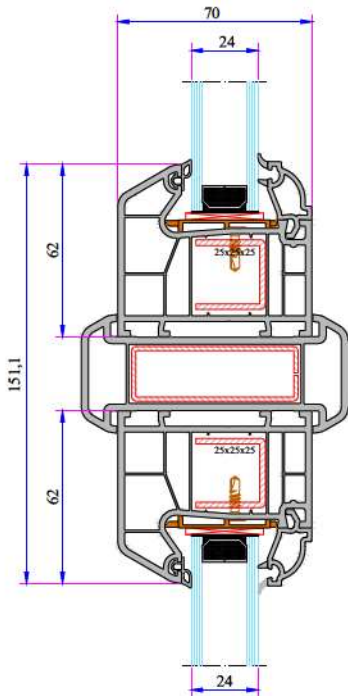

Large Coupling Profile Installation

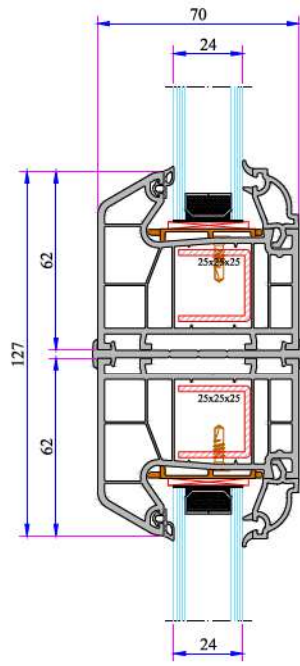

Narrow Coupling Profile Installation

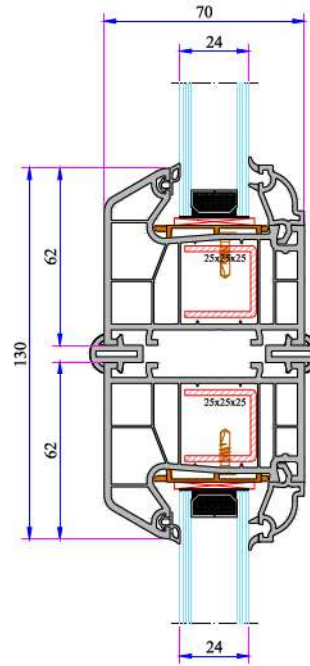

Short Coupling Profile Installation

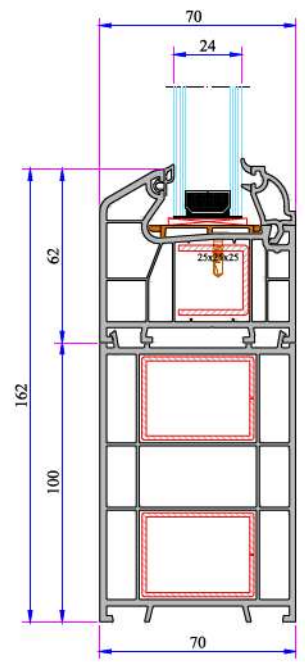

100mm Frame Lifting Profile Installation

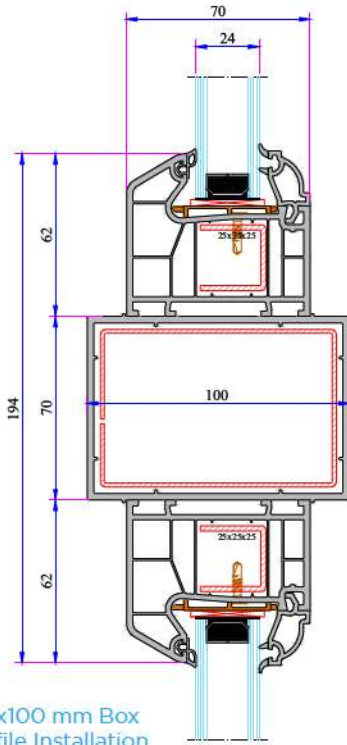

70x100 mm Box Profile Installation

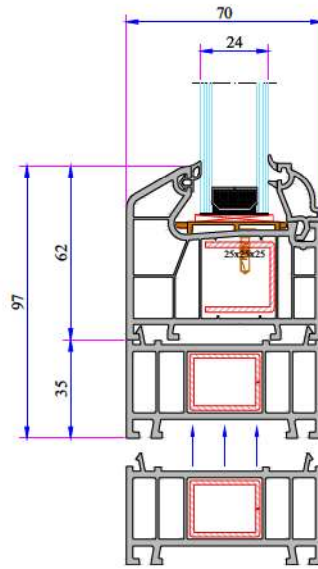

35mm Frame Lifting Profile Installation

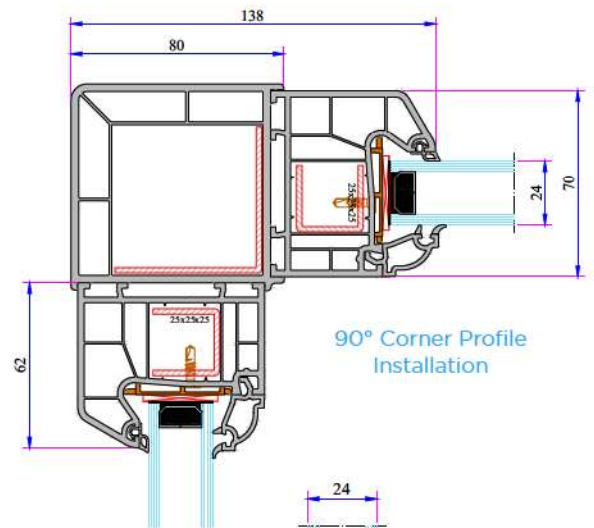

90° Corner Profile Installation

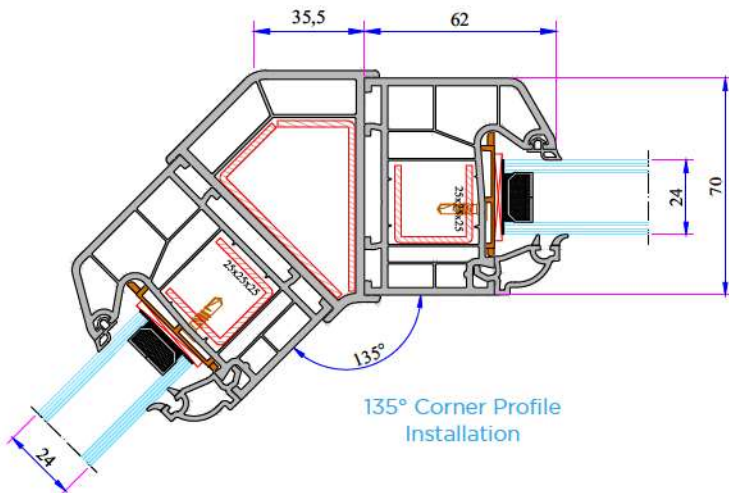

135° Corner Profile Installation

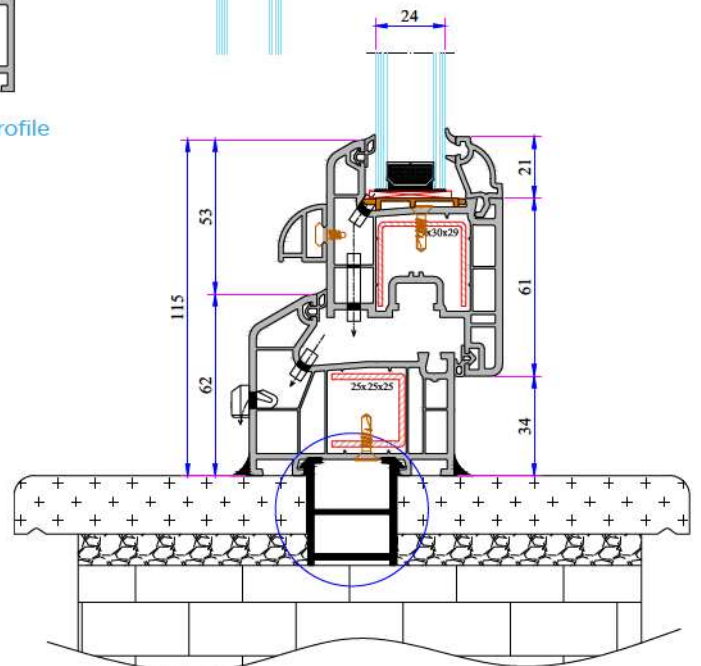

Offset Profile and Montage Profile Installation

Project name:	ADOPEN 760		
	SERI Uf		
Transmittance (Uf):	1.4573 W/m ² K	Internal T:	20.00 °C
Conductance (Lf2D):	0.3428 W/mK	External T:	0.00 °C
Frame length (Bf):	115.00 mm		



Thermal transmittance (Uf) computation performed in accordance with EN ISO 10077-2:2012

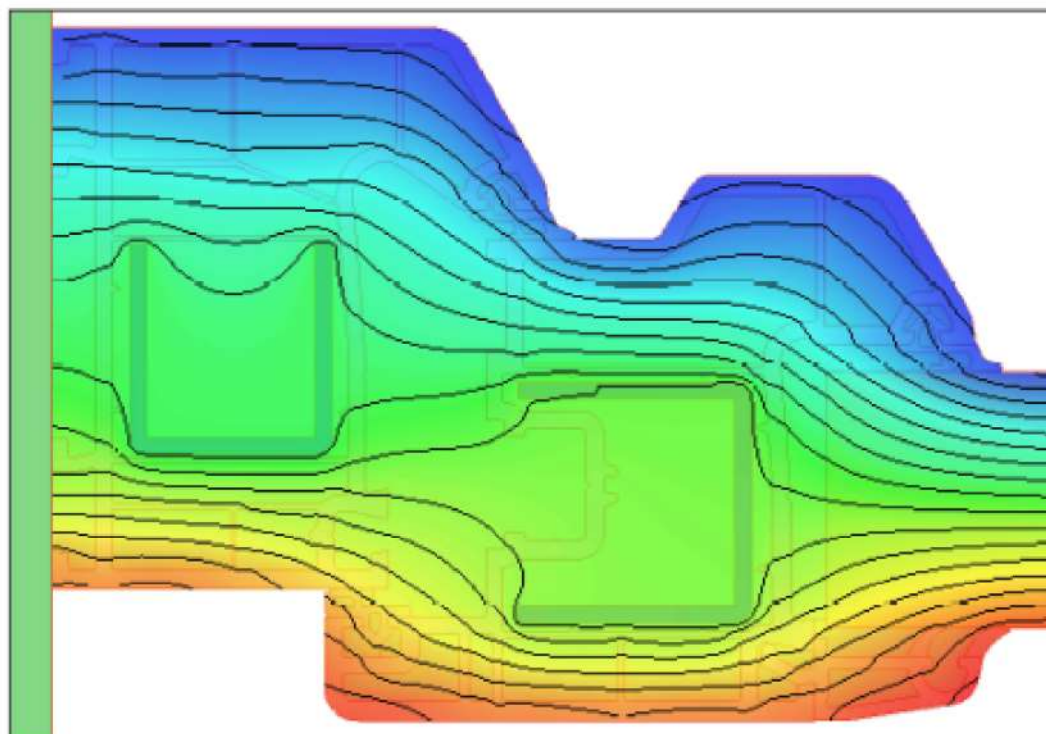

Node details

<i>Primitives used for finite element simulation:</i>	20036
<i>Frame width (Bf):</i>	115.00 mm
<i>Visible insulation panel width (Bp):</i>	190.02 mm
<i>Insulation panel thickness (Dp):</i>	35.20 mm

External boundary conditions:

<i>Temperature:</i>	0.00 °C
<i>Surface resistance:</i>	0.040 m ² K/W

Internal boundary conditions:

<i>Temperature:</i>	20.00 °C
<i>Surface resistance:</i>	0.130 m ² K/W
<i>Humidity:</i>	65.00 %

Results computed in accordance with EN ISO 10077-2:2012

<i>Internal/external temperature difference:</i>	20.00 °C
<i>2D conductance (Lf2D):</i>	0.3428 W/mK
<i>Transmittance (Uf):</i>	1.4573 W/m²K



FACTORY

Antalya Organize Sanayi Bölgesi 2.Kısım Mah. 21.Cadde No:3

07040 Döşemealtı / ANTALYA / TURKEY

Tel : +90 242 236 20 00 · Faks : +90 242 236 20 90 · Email : info@adowin.com.tr

